



Technical Specifications Packet

Metropolis Performing Arts Centre
111 West Campbell Street
Arlington Heights, IL 60005

Box Office: 847.577.2121
Phone: 847.577.5982
Production Management: Ext. 222

Metropolis Performing Arts Centre

Contents

Page 3	Stage
Page 4	Sound
Page 5	Sound (cont.)
Page 6	Lighting
Page 7	Miscellaneous
Page 8	Cabaret Seating
Page 9	Building Ground Plan
Page 10	Stage Layout
Page 11	Lighting Grid
Page 12	House Rules
Page 13	House Rules (cont.)
Page 14	Directions

Metropolis Performing Arts Centre

Stage

Dimensions:

Proscenium opening	Width:	46'5"
	Height:	19'7"
Plaster line to upstage crossover		21'0"
End of thrust to upstage crossover		43'0"
Half thrust to upstage crossover		35'0" (default)
Stage left wing		13'4"
Stage right wing		8'10"
Grid height over stage from deck		20'11" (fixed grid hanging only)
Grid Height over Thrust		20'9"
FOH catwalk to Plaster Line		33'4"
Stage height from floor		2'10"
Loading Door		8'x7'6"

Load-In:

A Load-In must be scheduled well in advance to secure availability of the loading dock. The loading doors are located upstage left via the loading dock located from the west side of the building (Highland Ave.) No loading ramp is kept in-house. The loading dock is at stage level (street level). Access to stage is straight and immediate. Dimensions of the door are 8' tall x 7'6" wide

Stage Floor:

The floor is sprung, 3 layered $\frac{3}{4}$ " plywood, covered with black tempered masonite.

Screwing, nailing, drilling, or stapling into the stage floor is permitted upon request. If you puncture the stage in any way without written consent, we will impose an additional charge for repairing the stage.

Soft Goods:

Main Drape: Manually operated stage right with center opening. Black in color.
4 borders
2 sets of legs (one set is dead hung, the other is on I-beam tracking SL to SR)
2 stage travelers (full stage curtain): 1 at mid stage, 1 at $\frac{3}{4}$ stage (manual)
1 black scrim
1 cyclorama - 20' 7"h X 62'w - this is in a fixed position and is not moveable

All soft goods are dead hung, they only move upon an approved written request.

Metropolis Performing Arts Centre

Sound

Mixers:

- 1-Mackie 40 x 8 SR40-8 (console has mute cueing capability)
- 1-Mackie 16 x 4 CR 1604-VLZ

Outboard rack (in order of placement):

- 1 Furman PL-Plus power conditioner
- 4 Rane 1/3 octave equalizers
- 2 Yamaha SPX990 Effect Processors

Playback:

- 1 Marantz PMD320 CD player
- 1 JVC XL-V75 CD player
- 1 Sony MDS-JE630 mini disk player
- 1 Marantz PMD502 cassette recorder
- 1 Yamaha KX-R430 cassette recorder

Speakers (All speakers are dead hung and are not moveable):

- 2 EAW LS832 (mounted to proscenium)
- 4 Renkus-Heinz SR-28/9 3 way 90x40
- 2 Renkus-Heinz CT7215/94
- 4 Renkus-Heinz TRC62/9 Full range 2 way passive
- 2 Renkus-Heinz TRC81/9 Full range 2 way passive

Amps:

- 7 Mackie 400/4 ½ M 1400
- 4 Mackie 700/4 ½ M 2600
- 2 Mackie 450/8 ½ M 2600
- 2 Mackie 250/8 ½ M 1400
- 1 Mackie 2000w/70 volt M 2600

Stage Monitors:

- 5 Electro Voice FM-1220ER

Wireless Mics:

- 2 Comteck Lav MR-182/m-72C w/ MKE-2-5 mic - Frequency 213.05 & 214.125
- 2 Vega UHF with Handheld w/ Beta 57 Element - and Lav packs w/ B3 element
Both on Frequency 728.2 with switchable channels

Metropolis Performing Arts Centre

Sound (cont.)

Mics:

4 Shure SM-58	1 Shure Beta SM-58A
4 Shure SM-57	1 Shure Beta SM-57A
2 Shure SM-81C	1 Countryman Podium Hypercardioid
2 Sennheiser MD421-II	2 EV RE90H hanging choir mics
4 Electro Voice RE-16	2 Crown PCC-160

Misc:

4	Whirlwind D.I. boxes
4	mic stands w/boom
6	mic stands straight-tripod type
4	mic stands straight-heavy type
2	desk/table mic stands
4	boom arms
8	mic cables - 3ft
4	mic cables - 5ft
7	mic cables - 10 ft.
10	mic cables - 25 ft
4	mic cables - 50 ft.
1	16 channel sub snake - 50ft
1	7'6" Yamaha Grand Piano* - black

*use of the piano must be approved by Director of Production

Intercom:

We have a 2 channel Clear Com system. Channel A feeds the dressing rooms and Box Office. We have 2 main stations. One at the stage managers position, and one in the lighting booth. There are various panels throughout the theater that will accommodate any of four channels. We have a total of 4 belt packs, 6 headsets, and 1 handset.

There is a program feed that comes from the sound console that feeds all dressing rooms, hallways, and the lobby area.

The theater is equipped with a Sennheiser IR listening assistance system with a total of 6 headsets. It is fed directly by 2 PZM mics mounted on the rear wall of the theater. These microphones are the same microphones used for the lobby/dressing room monitors.

Metropolis Performing Arts Centre

Lighting

Control:

ETC Expression 3 (400 channels)

Inventory:

9	Altman ground row cyc units (these units are prepped to hang)
4	High End Studio Color 575 wash fixtures
2	High End Studio Spot 250 hard edged fixtures
5	50 degree Altman Shakespeare
20	40 degree Altman Shakespeare
12	30 degree Altman Shakespeare
6	20 degree Altman Shakespeare
6	6" Fresnel
24	Par 64
3	Par 56
8	26 degree Source Four
6	36 degree Source Four
4	19 degree Strand SL
4	26 degree Strand SL
5	Birdies w/ MR 16 lamp

Accessories:

4	12' booms with bases
2	followspot boomerangs & handles
37	pattern holders
4	Altman drop-in Iris
4	Source Four drop-in Iris
8	Donuts
15	2' side arms
6	barn doors
26	Altman top hats

Light focusing is done by ladders and our one upright lift. The only focusing done by a catwalk is the foh.

We have various ladders and (1) 25' Upright motorized lift.

All lighting paperwork, including the plot, is due a minimum of 6 weeks prior to the date of the hang.

Metropolis Performing Arts Centre

Miscellaneous

Stage Manager:

Stage Manager's panel is located stage right and is equipped with House light control, silent video monitor, 2 channel Clear Com, and work light control.

Rehearsal Room:

We have several spaces available in varying sizes. Two month notice must be given to insure that a space will be available.

Dressing Rooms:

The second floor contains the two primary dressing rooms. Each is designed for 6-10 adults. The second floor also contains the green room, which is located between the two dressing rooms. Access to the stage is by private corridors and stairways. All rooms contain at least 1 sink (hot and cold water), wardrobe rack, lighted mirrors, counter, 1 private bathroom, and 1 shower stall.

Wardrobe:

We have a stack washer/dryer unit for laundry. Large items may not fit. We also have 1 iron with ironing board and 1 steamer. There are limited wardrobe/laundry supplies kept on hand. Use of these may cost extra.

Metropolis Performing Arts Centre

Cabaret Seating Arrangement

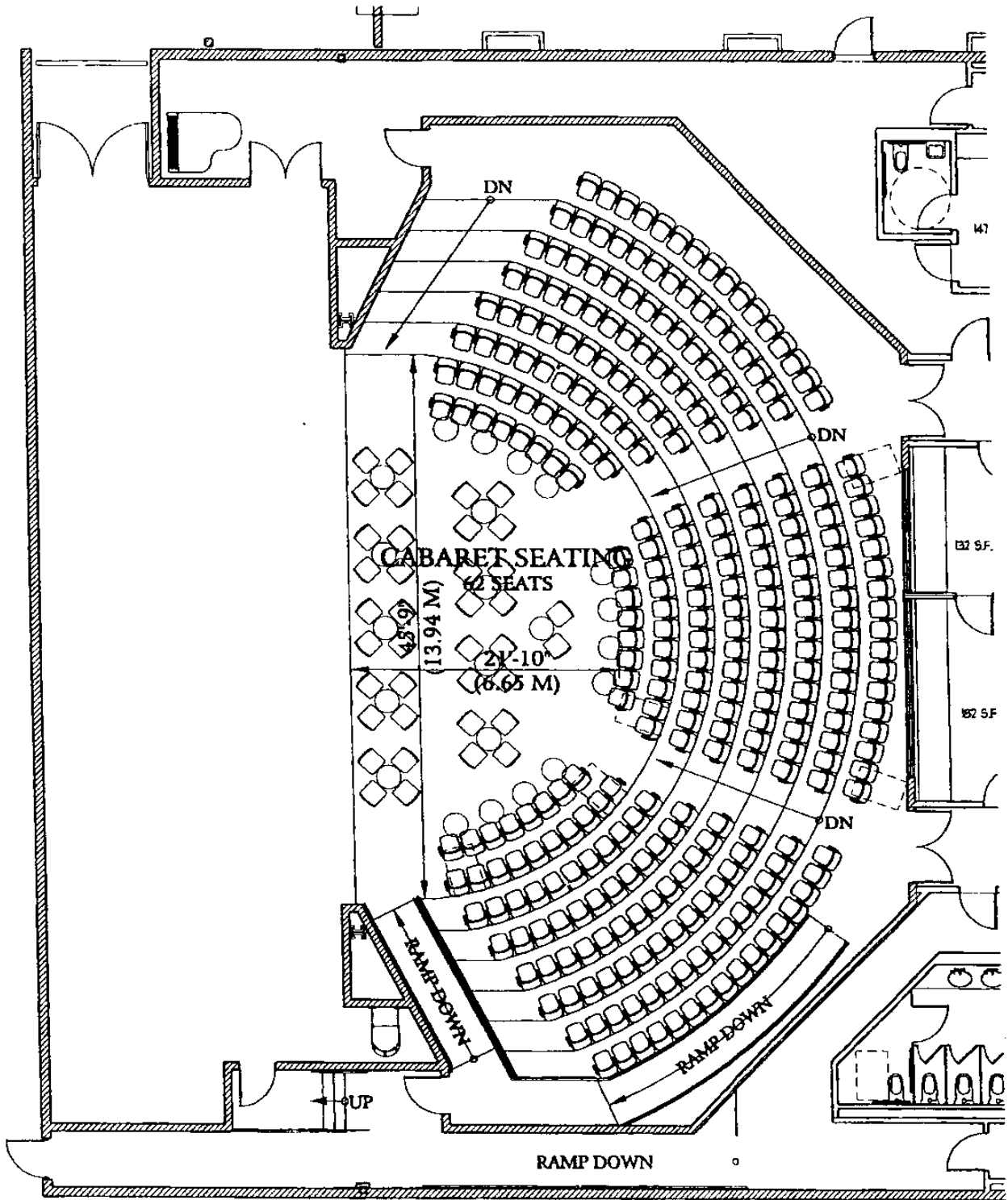

NOT TO SCALE

Metropolis Performing Arts Centre

Building ground plan - First Floor

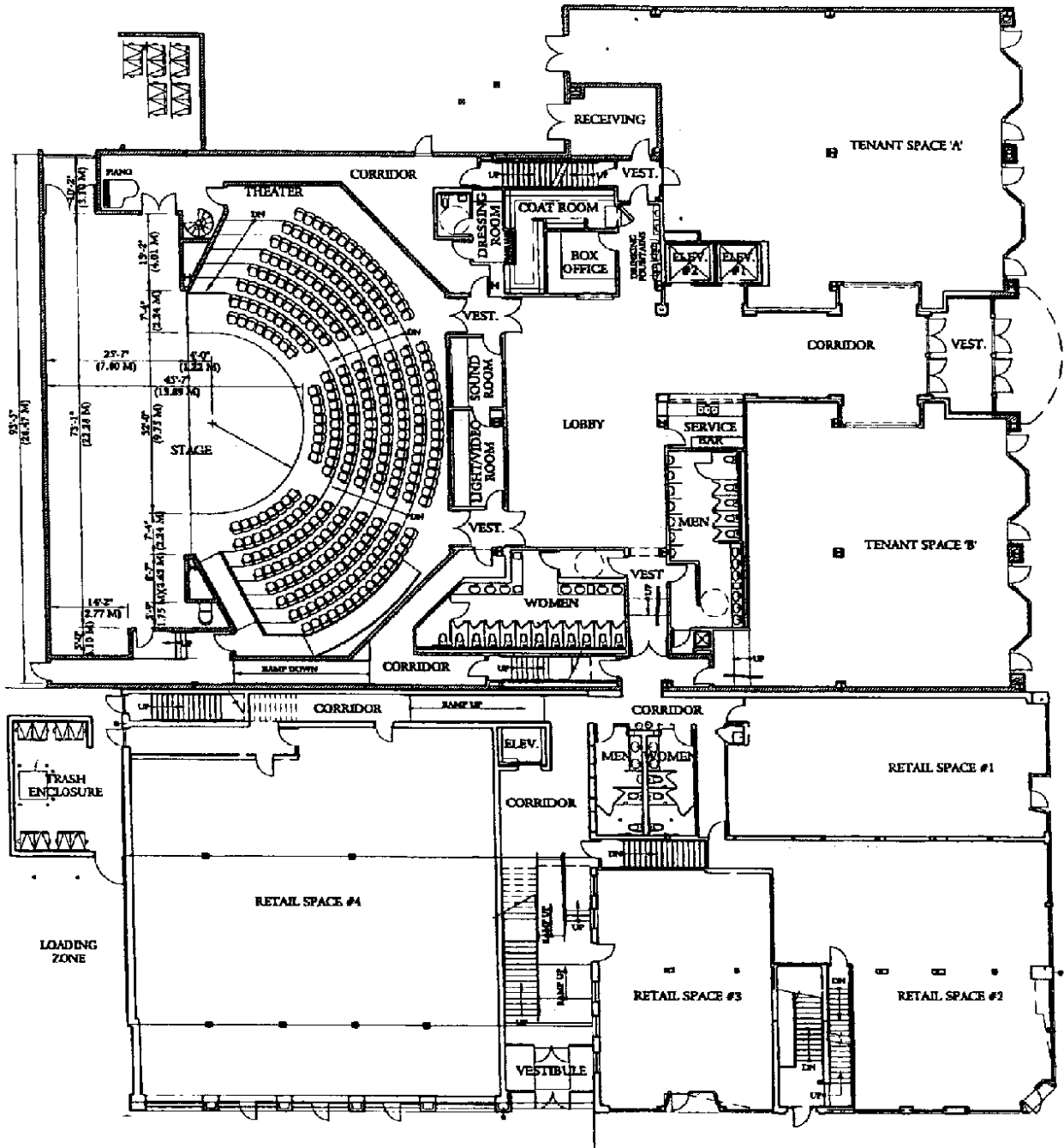

NOT TO SCALE

Metropolis Performing Arts Centre

Stage Layout

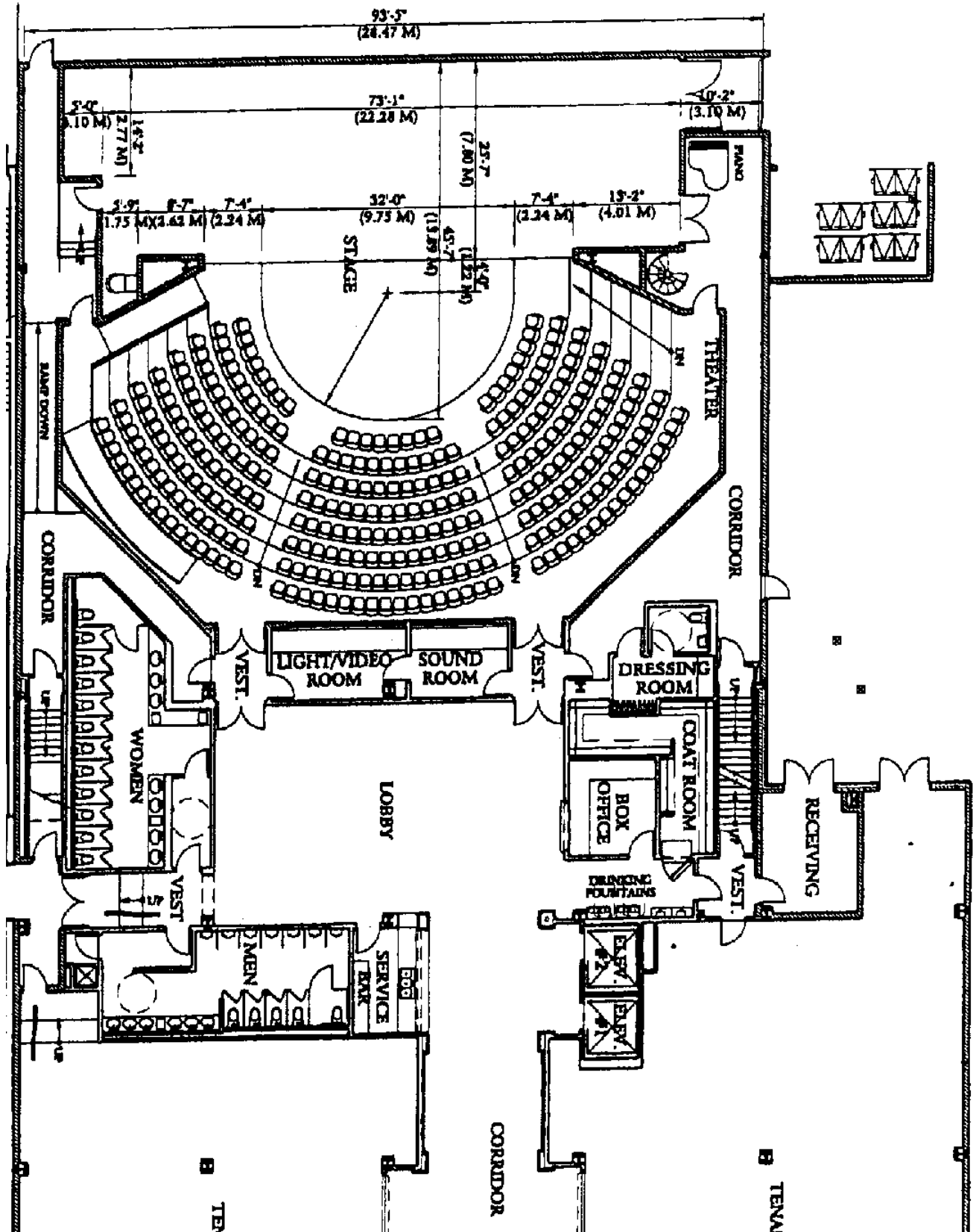

Metropolis Performing Arts Centre

Lighting Grid and Hanging Positions

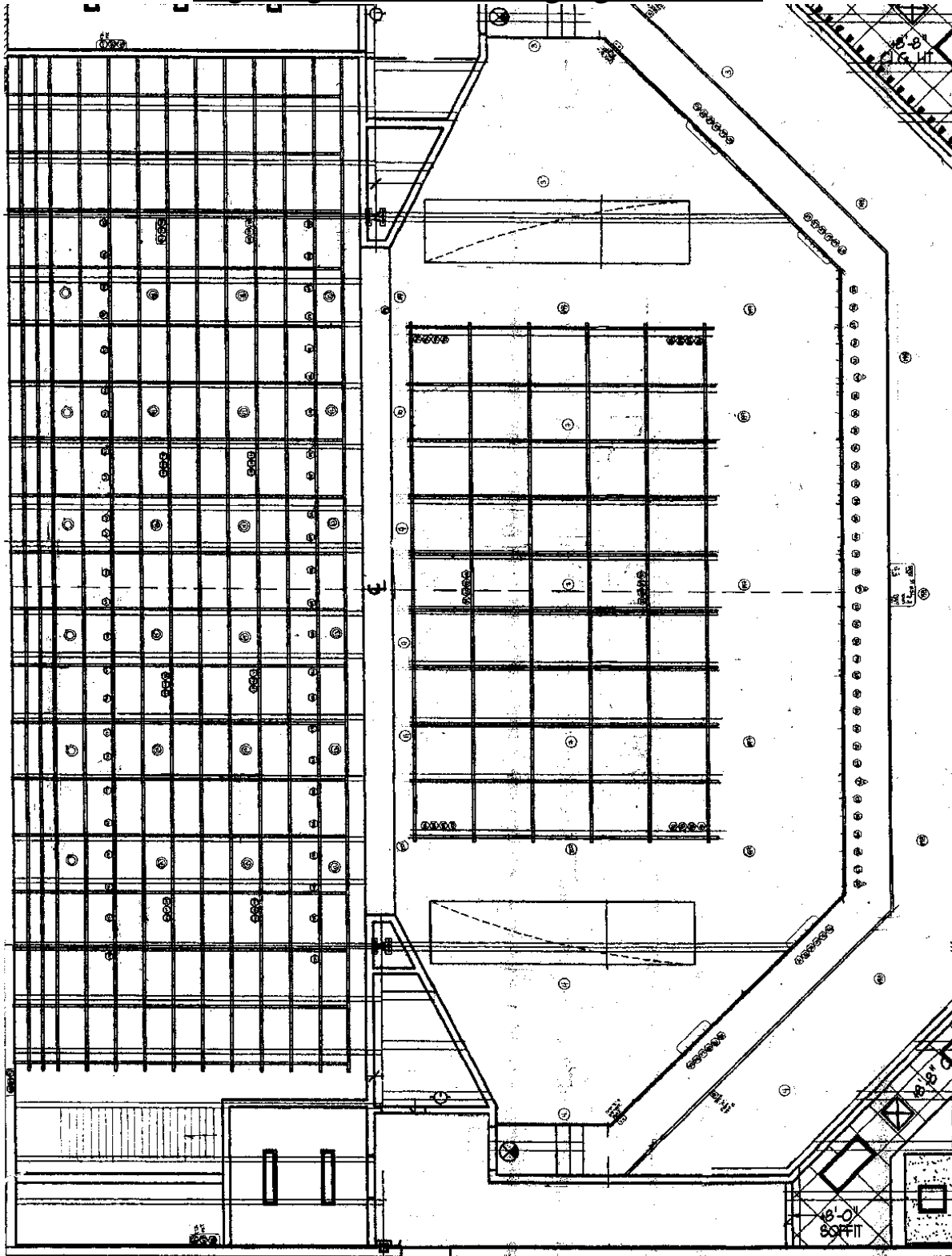

NOT TO SCALE

Technical Packet

Metropolis Performing Arts Centre

House Rules

Welcome to Metropolis Performing Arts Centre

In order to familiarize you with some of Metropolis's policies and procedures, we have compiled the following notes. We hope they will serve as a useful source of information for you. Policies set forth in this document are subject to change. As changes occur, we will try to communicate the information to you in a timely fashion.

Smoking

Smoking is not allowed in any space inside the building. Smoking is permitted outside. Please dispose of butts properly. Doors are not to be propped open or left ajar.

Telephones, Phone Calls, and Messages

There are no pay phones located in the building. Cell phone may be used throughout the building and in the theatre during non-show times. The phones in the dressing rooms are for internal use only to contact the box office or stage manager in the case of an emergency. Clear Com is also available.

Valuables and Personal Belongings

Metropolis Performing Arts Centre, due to the large number of groups using the facility, cannot be responsible for valuables or belongings left around the theatre, dressing rooms, classrooms or lobby area. Please be cautious with personal belongings at all times. Each company should place items in their designated area prior to leaving.

Green Room/Dressing Rooms

Please be respectful of the areas that you are using. Throughout the season there can be many different companies sharing the same space within a given day. Please pick up after yourself and dispose of waste in proper receptacles. Stage Management is ultimately responsible for returning the theatre to its original state.

Food & Beverage

In accordance with FDA and the Village of Arlington Heights Health Inspection Codes, food and beverages are to be kept strictly to the immediate area of the green room. Food and beverages must be stored solely in designated areas. Only water in sealed containers (any bottle or container with a lid or closeable top) is allowed in the dressing rooms, rest rooms, backstage, on stage, hallways, technical booth, and classrooms.

Metropolis Performing Arts Centre

House Rules (cont.)

Accident Reports

Please take the time to familiarize yourself with the areas in which you will be working. Accidents can be prevented through awareness of the work area. Stage management will be provided with an accident form to complete if needed.

Equipment

Only authorized personnel, as designated by the Director of Production, are allowed to operate house equipment and devices. All tools and instruments taken above stage level must have an attached safety line and have prior approval by the Director of Production. There are certain outlets designated specifically for audio equipment. Non-audio gear may not be plugged into these outlets. Any and all electrical devices must first be approved by the Technician on Duty BEFORE being plugged in.

Damages

Please be respectful of the facility and the other groups who use it. Any damages caused by artist or artist staff will be the responsibility of the artist staff.

Entering & Exiting the theatre

Performers must enter the theatre through the main theatre doors. Performers and technicians may exit through the stage doors as long as they make sure the door firmly shuts behind them.

Security & Other Areas of the Building

Metropolis is home to many programs concerning the performing arts. With all of this activity happening at the same times, it is important that performers and technicians work and stay only in the areas they are authorized to do so. Access to the catwalk, ladders, or any other climbing devices, must be authorized by the Director of Production.

Metropolis Performing Arts Centre

Parking

Parking is enforced. Please follow guidelines to avoid ticketing.

- 1) Parking is available on the 1st floor of the garage.
 - 1st floor is 3 hour parking until 6pm M-F
 - 1st floor is free after 6pm M-F
 - 1st floor is free ALL DAY Saturday and Sunday
- 2) Street parking around Metropolis.
 - 2 hour parking until 6pm M-Sat
 - Free ALL DAY on Sunday
- 3) Paved lot on Campbell and Highland
 - NO PARKING AVAILABLE
- 4) Residential Street Parking
 - Ridge, Walnut or Mitchell streets are free ALL DAY
 - Located 2-4 blocks west of Highland
 - Campbell (west of Ridge)

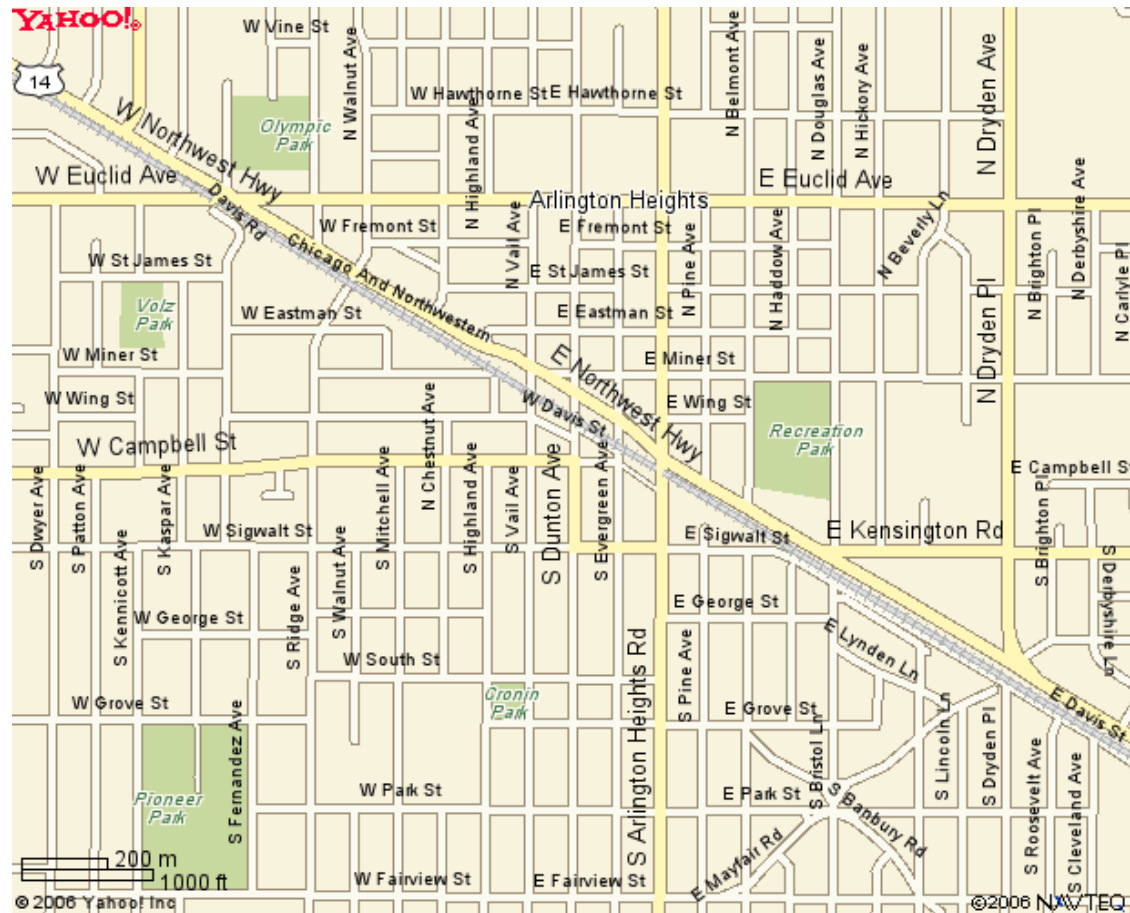

Metropolis Performing Arts Centre

Directions to Metropolis Performing Arts Centre

From the North

Taking 294:

Take 294 South and Exit on Willow Road (50 cent toll)
Make a right on Willow (traveling west)
Willow to Arlington Heights Road and turn Left (south)
Arlington Heights Road to Northwest Highway and turn Right
NW Highway to Vail and Turn Left
The Next Stop Sign is Campbell – Turn Right and the Theatre is on your left

Taking Highway 53:

Take Highway 53 South to Kirchoff
Go east on Kirchoff to Wilke and Take a Left
Wilke to Campbell Street and turn Right
The Theatre will come up on your Right

From the East

Using Golf Road or Central Road:

Travel West to Arlington Heights Road and turn right (North)
Arlington Heights Road to Sigwalt and turn Left
Sigwalt to Vail and turn Right
Vail to Campbell and turn left
The Theatre is on the left

From the West

Using 90 (the Kennedy Expressway):

Take 90 east to Arlington Heights Road (toll on exit) and go North
Arlington Heights Road to Sigwalt and turn Left
Sigwalt to Vail and turn Right
Vail to Campbell and turn left
The Theatre is on the left

From Chicago or O'HARE Int'l Airport

Using 90 (the Kennedy Expressway):

Take 90 west (toll) to Arlington Heights Road and go North
Arlington Heights Road to Sigwalt and turn Left
Sigwalt to Vail (third Stop sign) and turn Right
Vail to Campbell and turn left
Metropolis is on the left